

Briefcase:

pages 1 - 27

Shoulder strap from bag:

pages 28 - 29

-The number in the circle shows which holes are to be connected. Example: ①

-Numbers 1, 2, 3 (...) without a circle indicate where the piece lies in the overview drawing.

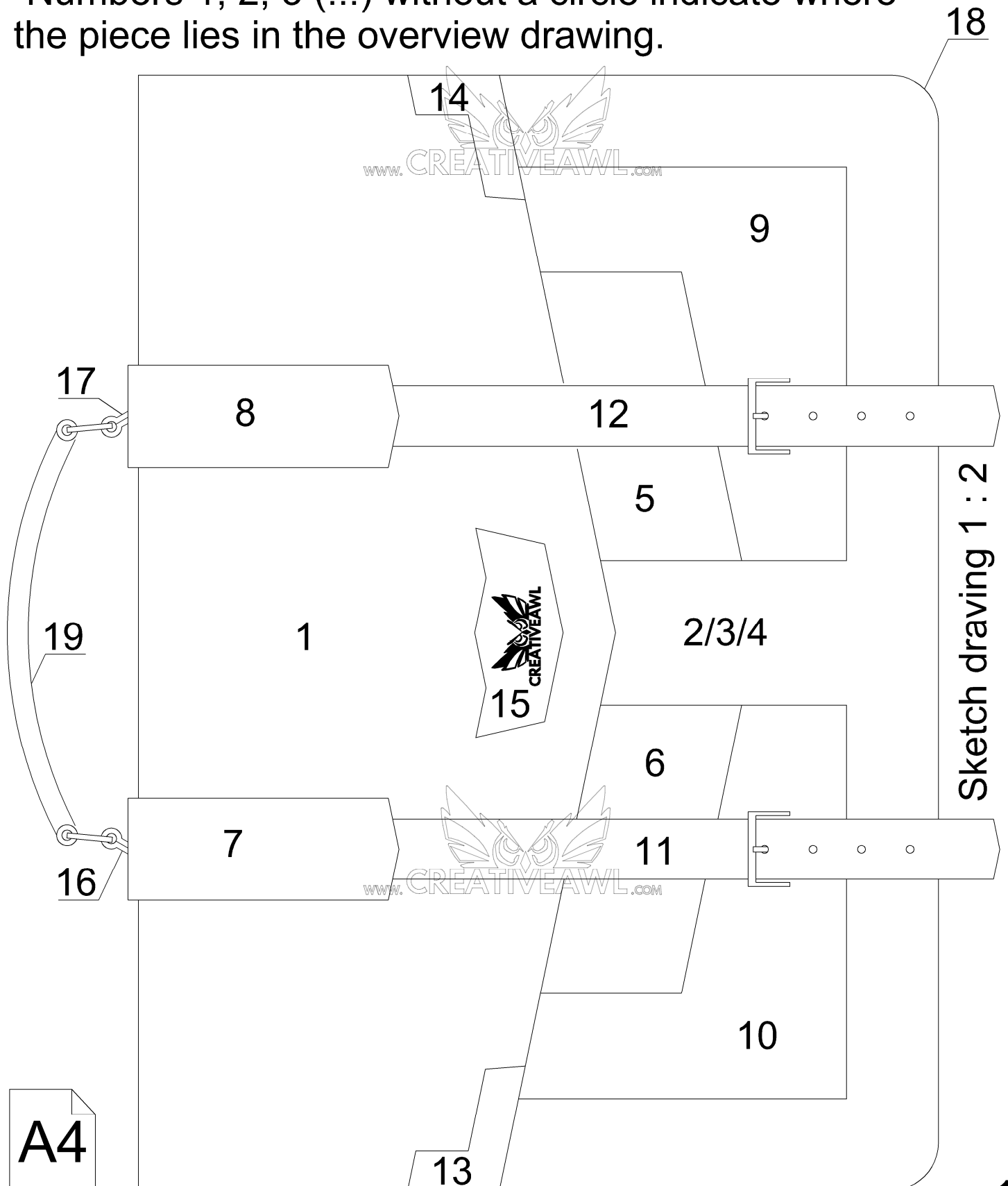

Leather needed for a bag: about 1,10 m2
787 mm (31,4 in)

1370 mm (54,6 in)

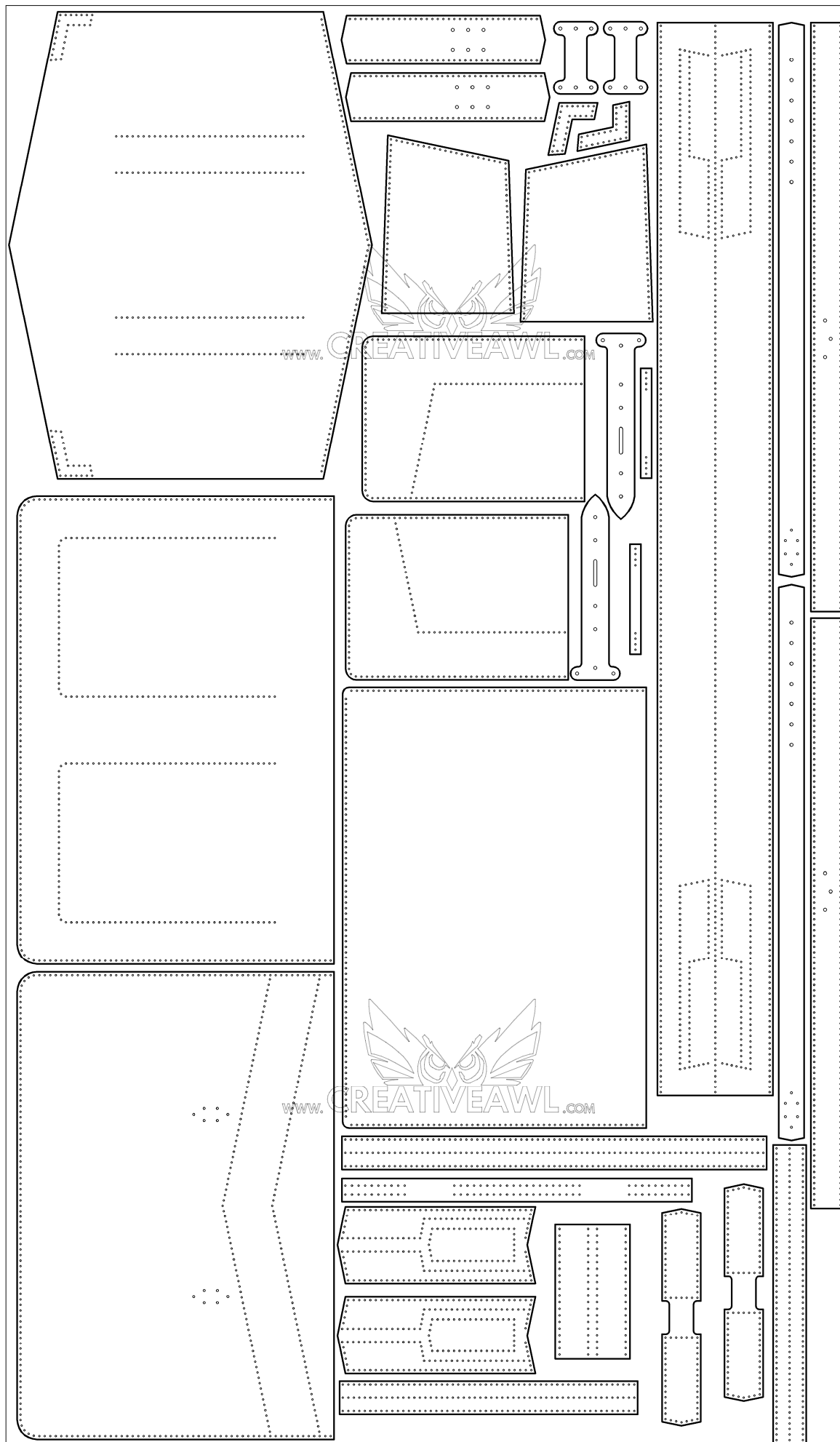

Bill of materials

Sketch drawing 1 : 5

A4

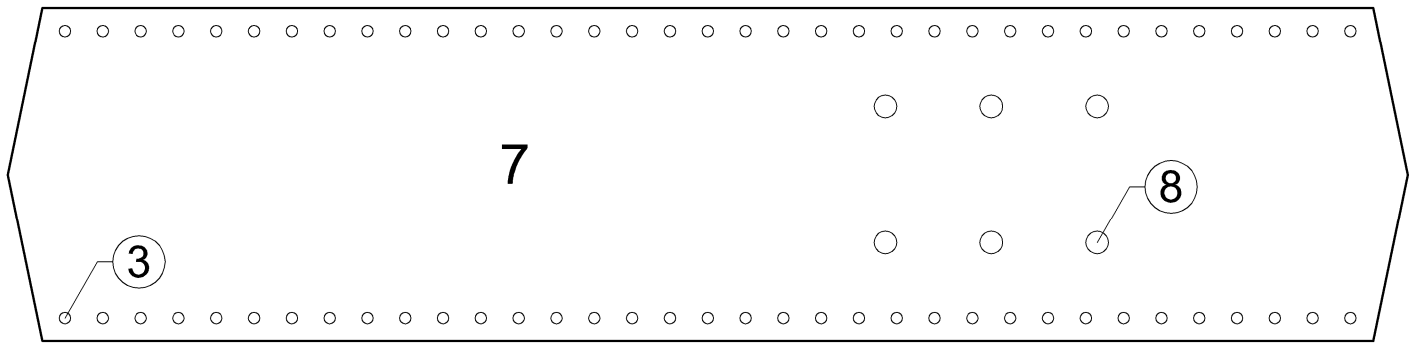

Flap and flap components

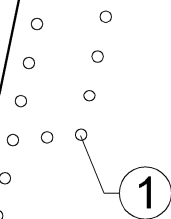
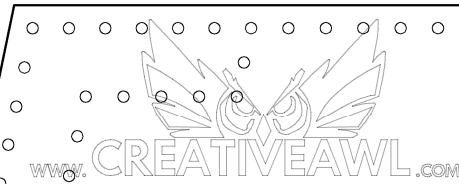
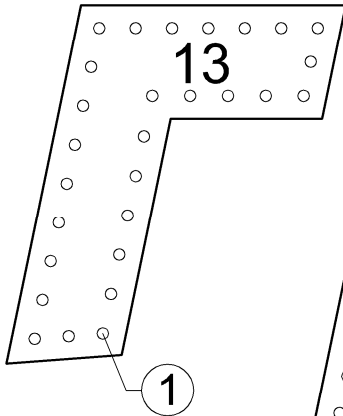

p1

1/1

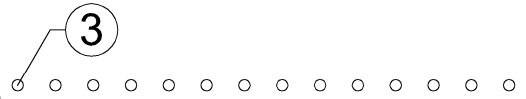

3

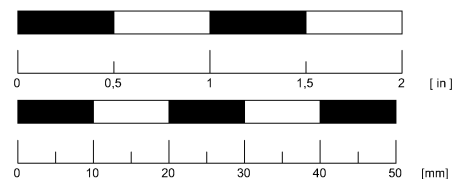
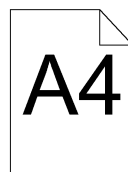

p2

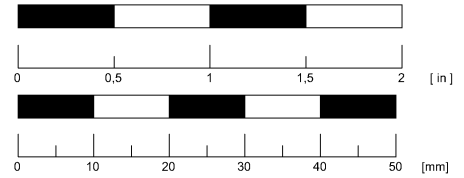
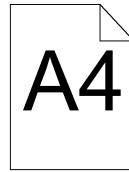
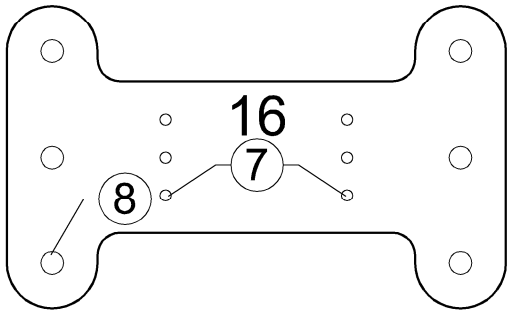

Flap and flap components

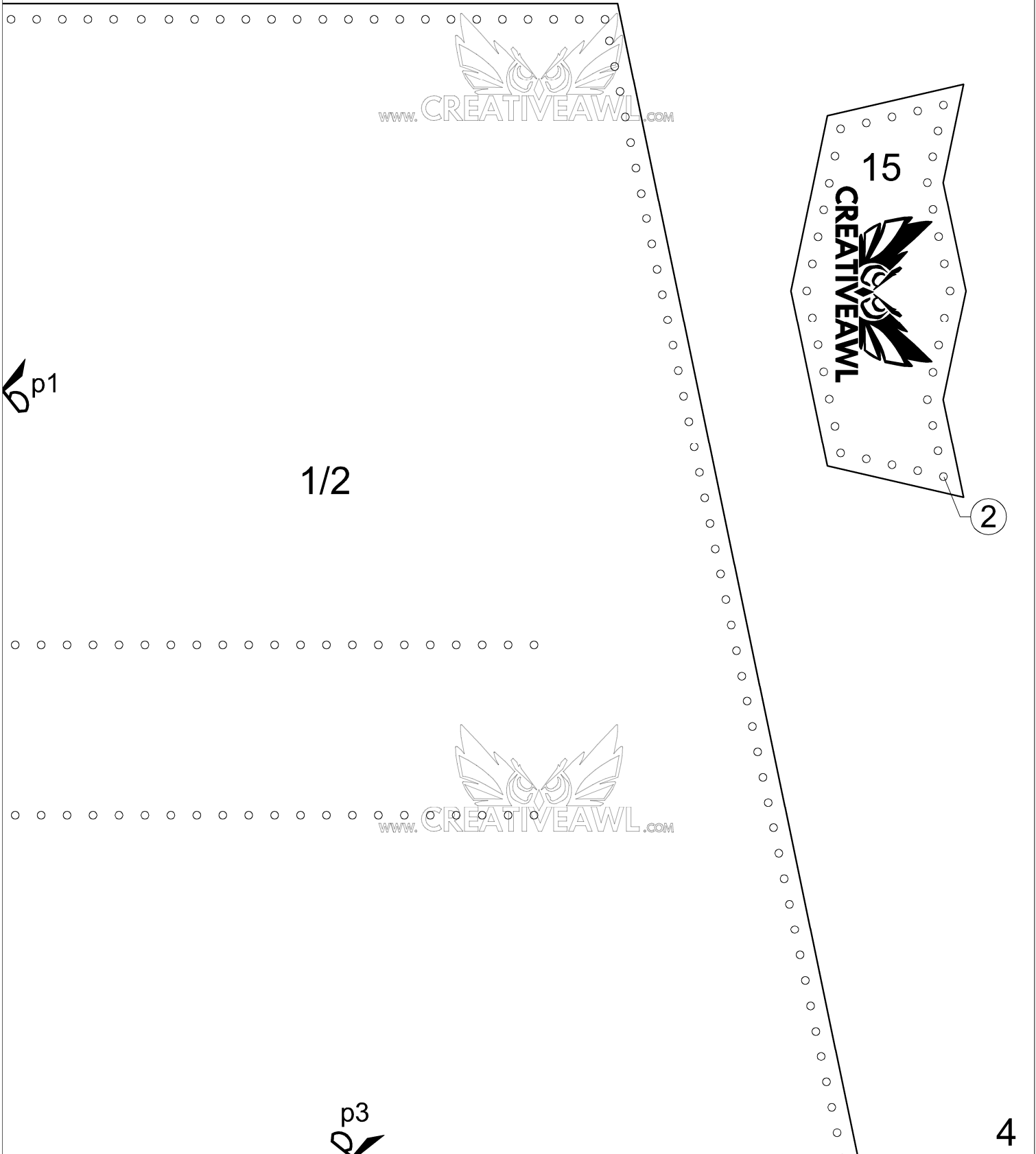

p2

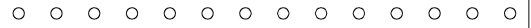
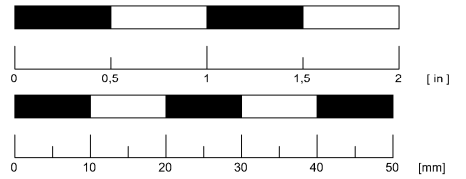
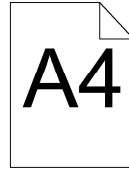

1/3

p4

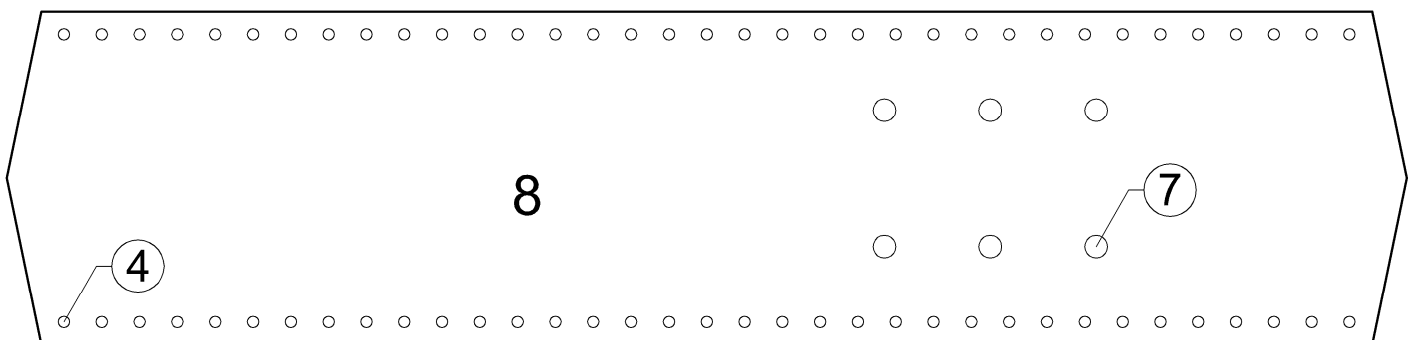
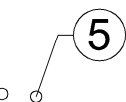
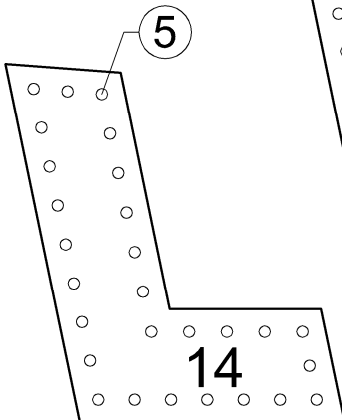

p3

9

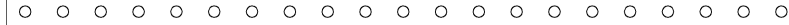
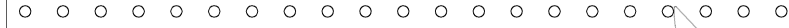

p4

1/4

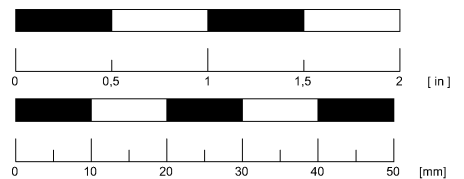
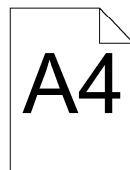
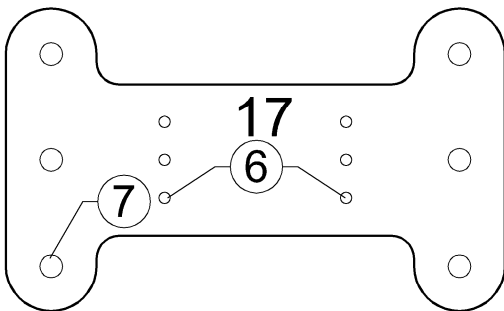
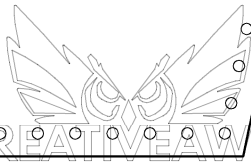
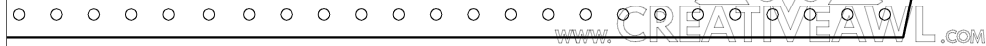

Flap and flap components

Front and pocket components

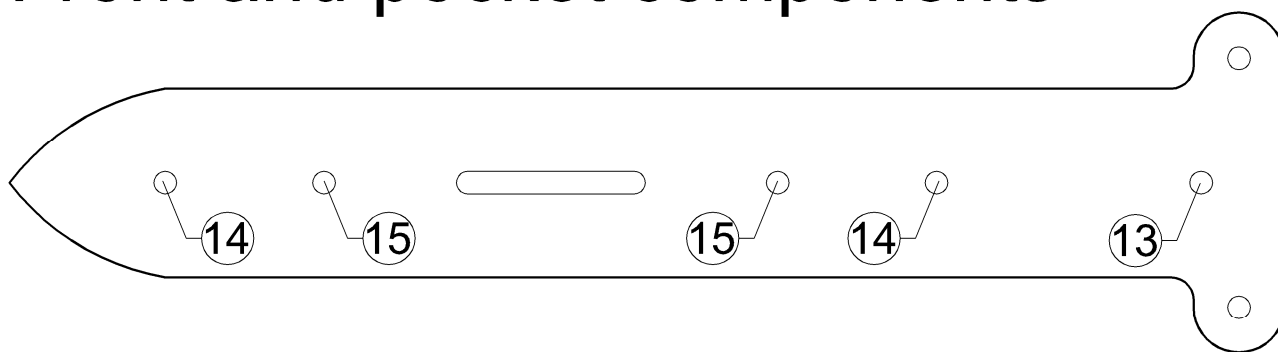

p5

2/1

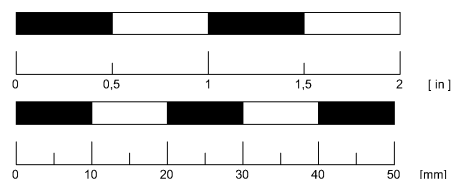
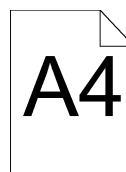

Front and pocket components

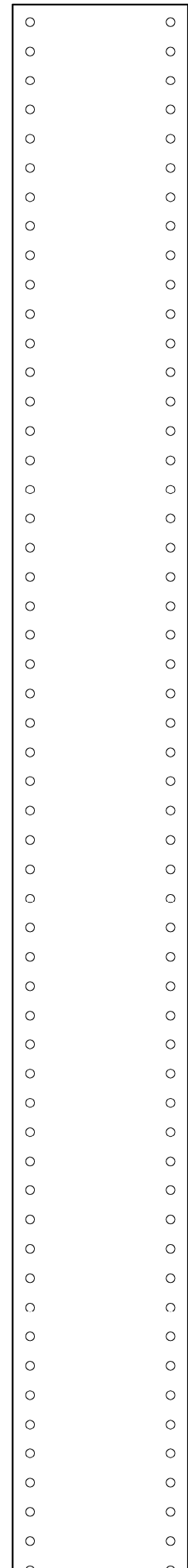
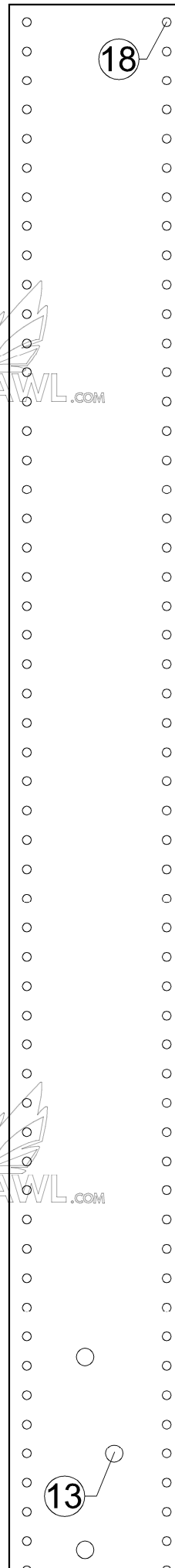
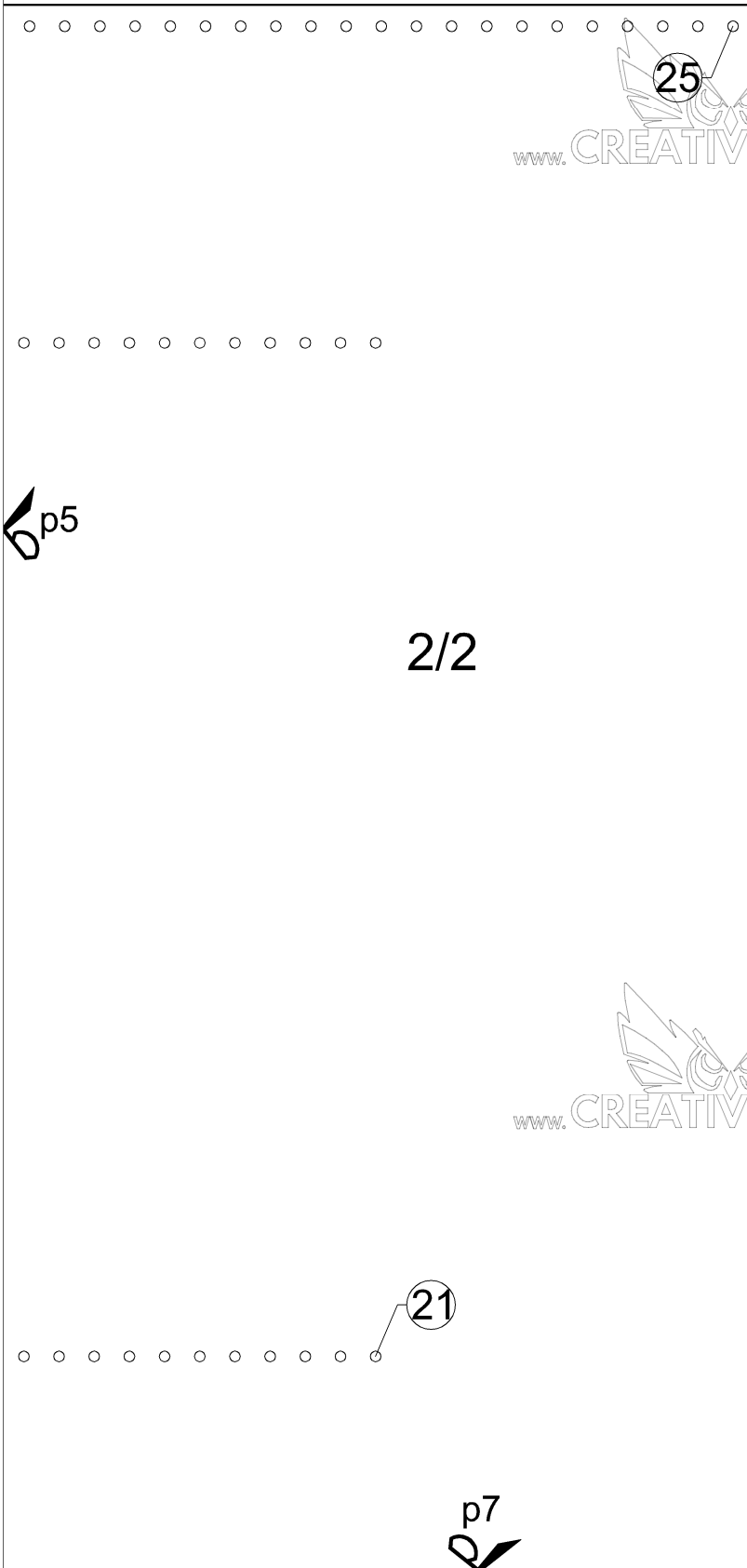
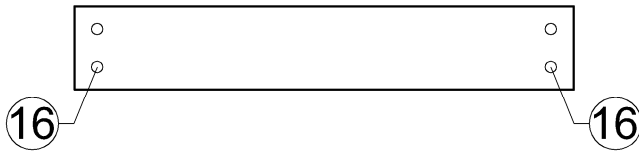
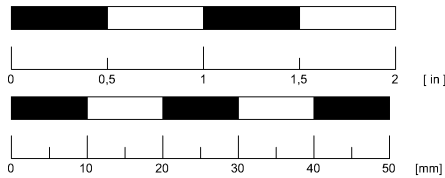
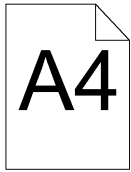

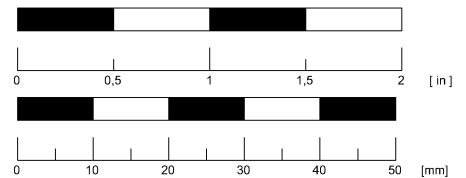
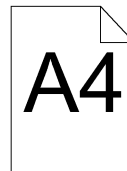

2/3

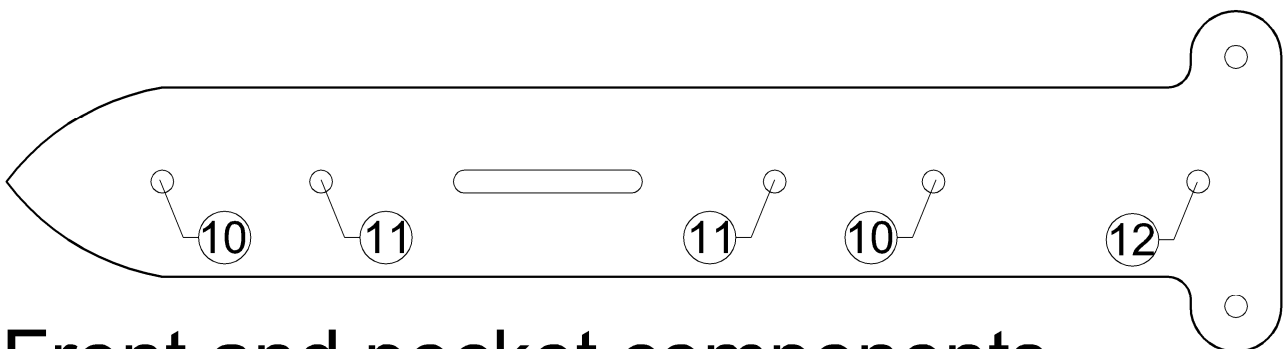
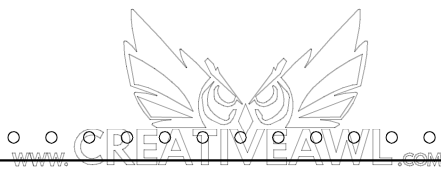

Front and pocket components

○ ○ ○ ○ ○ ○ ○ ○ ○ ○ ○ ○

6 p8

2/4

19

17

17

A4

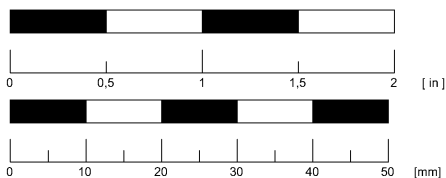

19

21

20

10

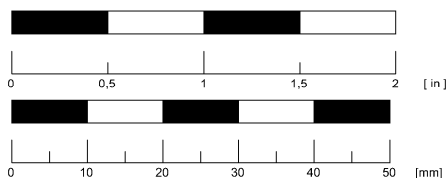
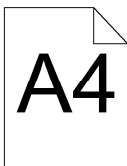
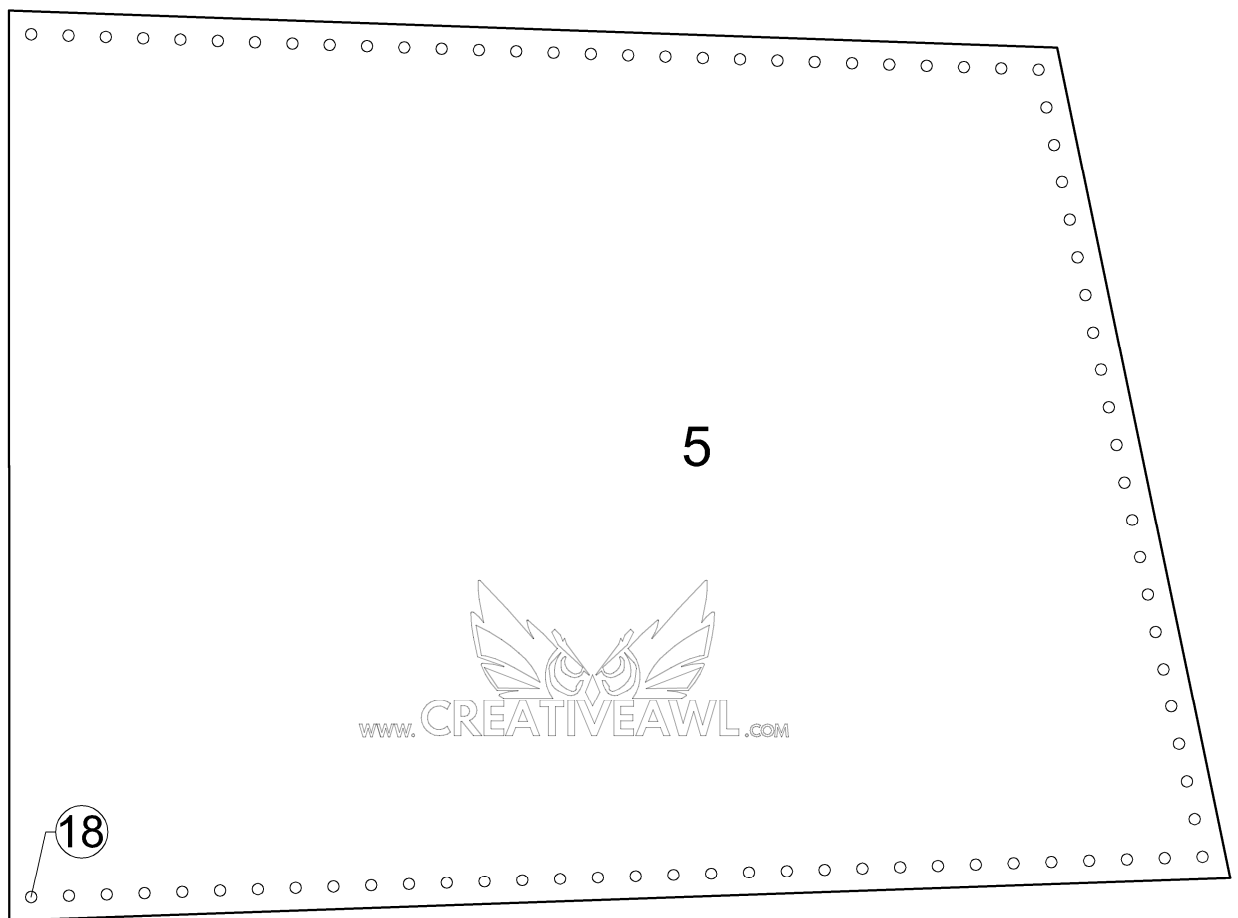
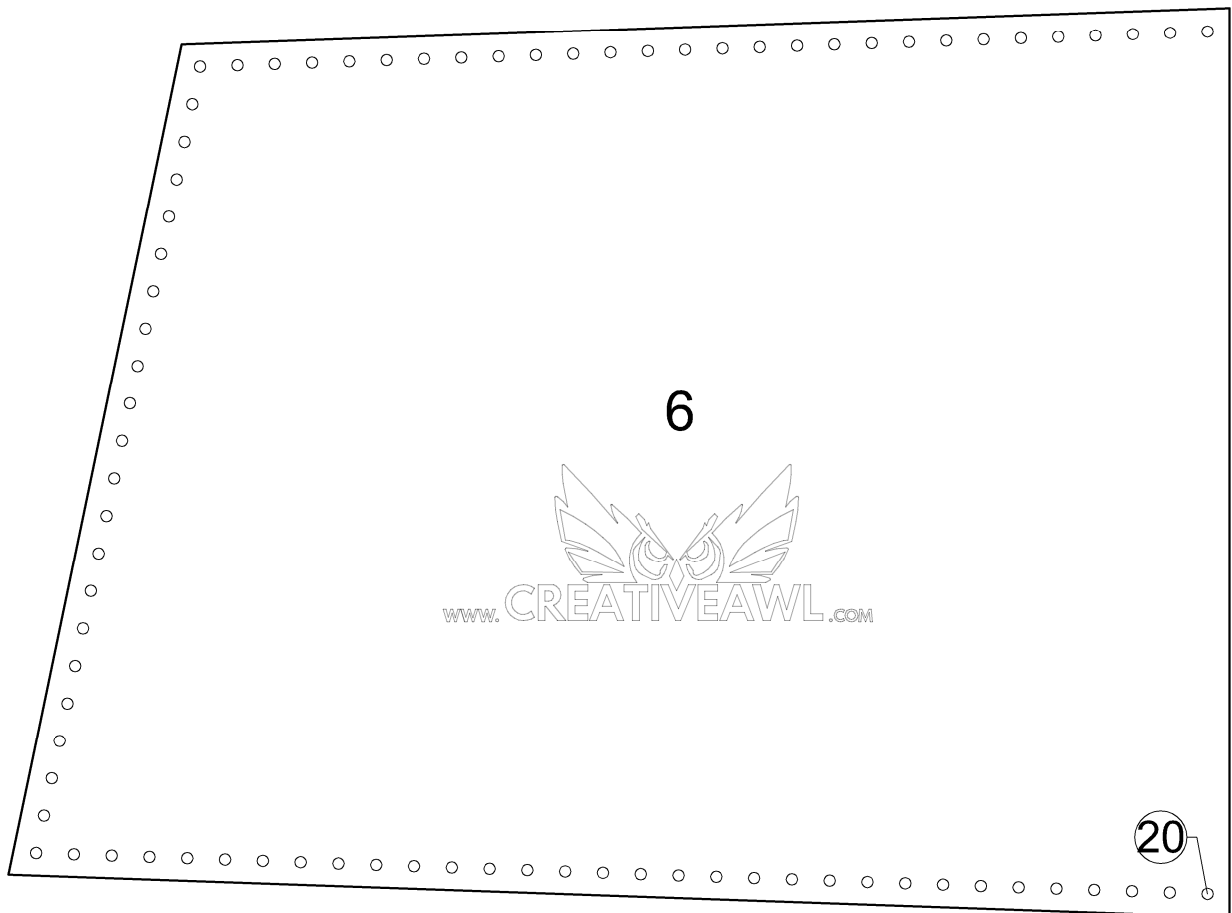

Small pocket

A4

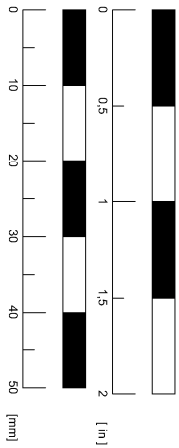

Big pocket and flap strips

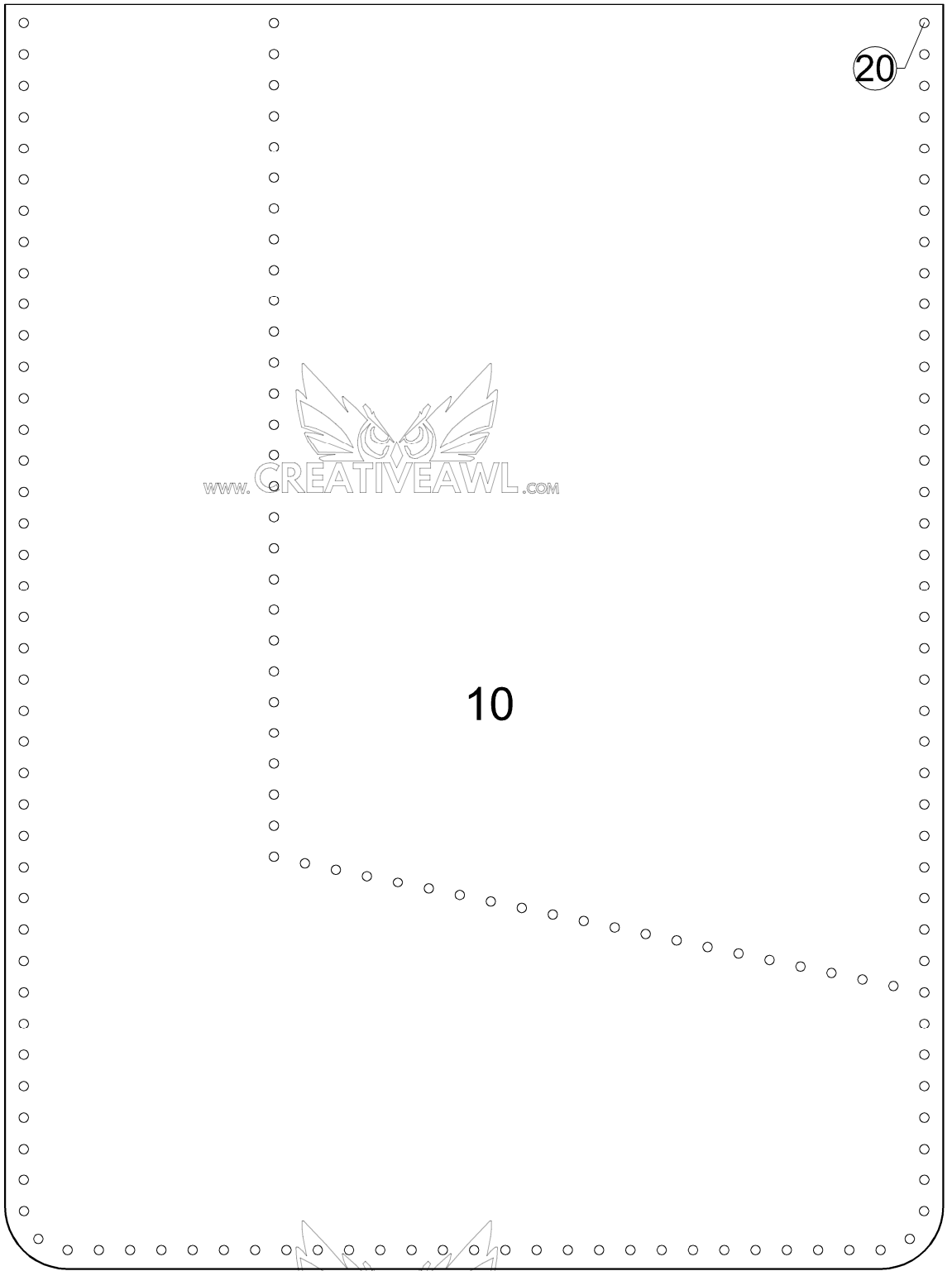

20

10

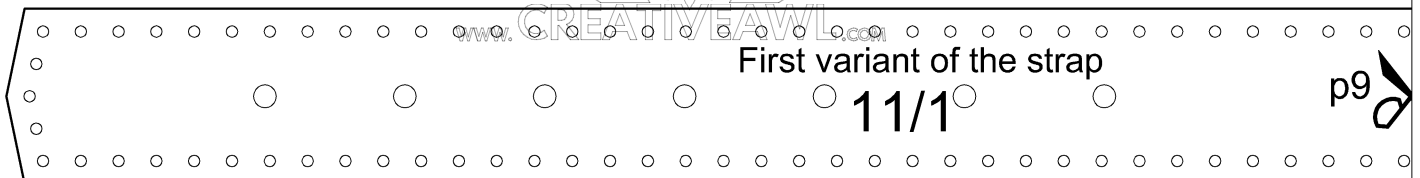

First variant of the strap

11/1

p9

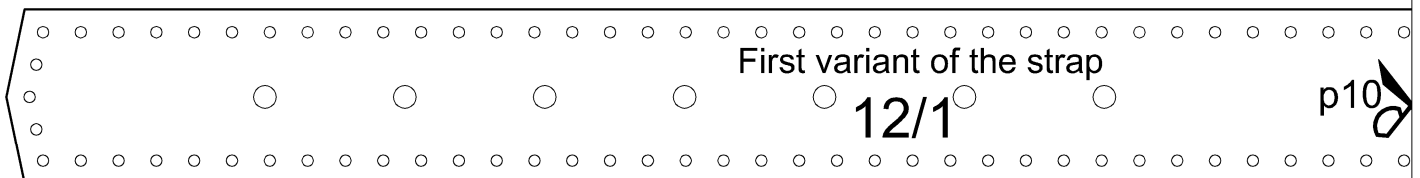

First variant of the strap

12/1

p10

A4

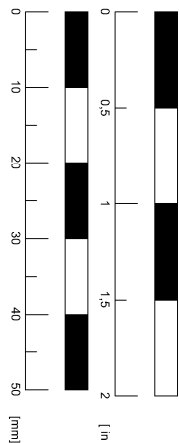

Big pocket and flap strips

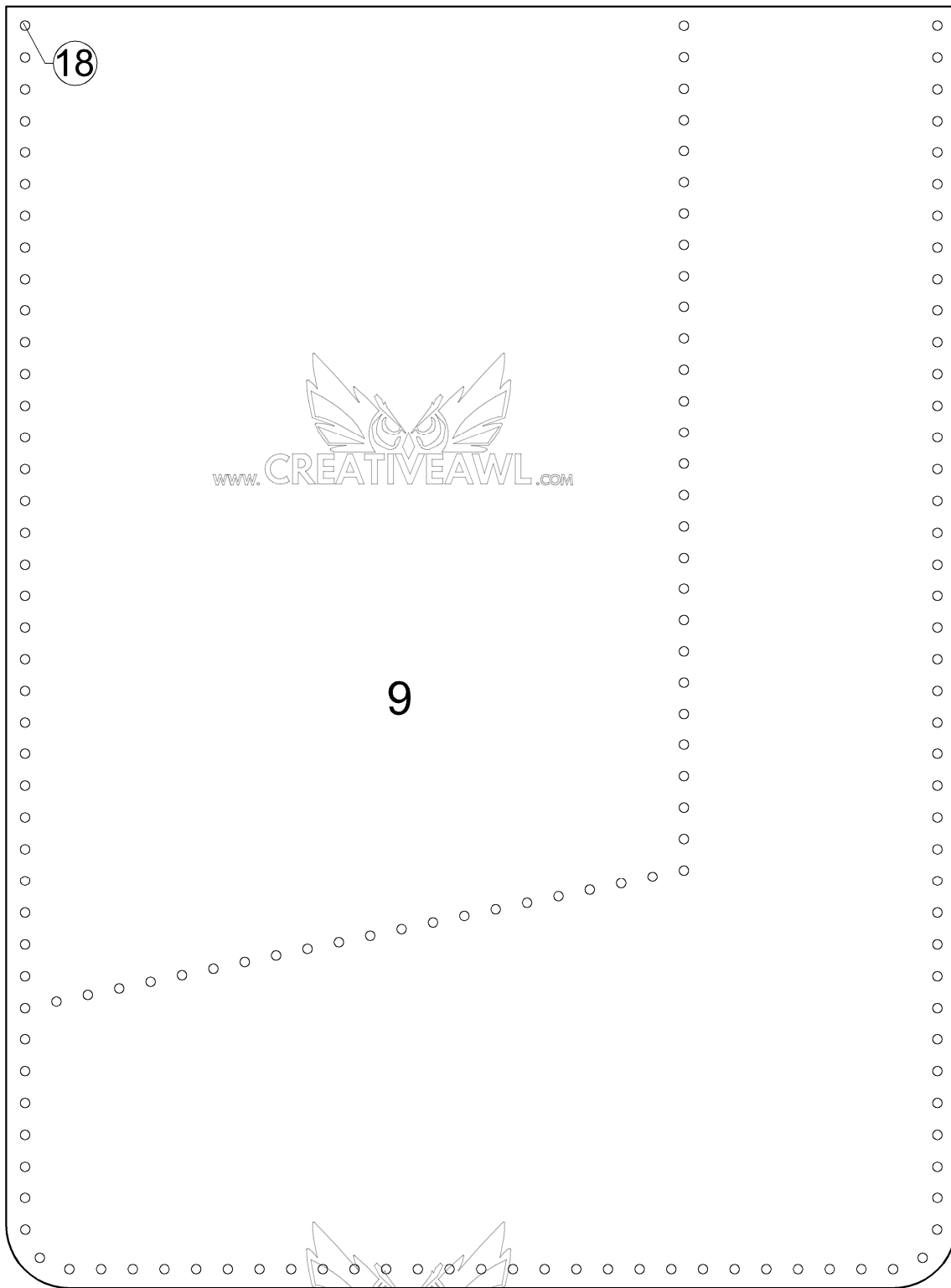

p9

www.CREATIVEAWL.com

First variant of the strap

11/2



p11



p10

First variant of the strap

12/2

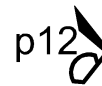

p12

Flap strips and sides components

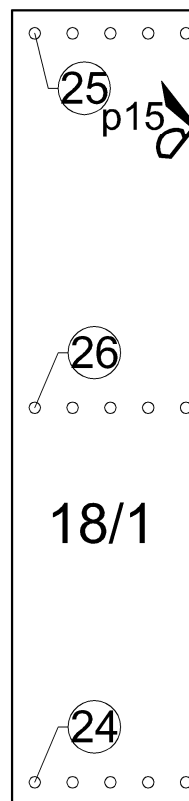
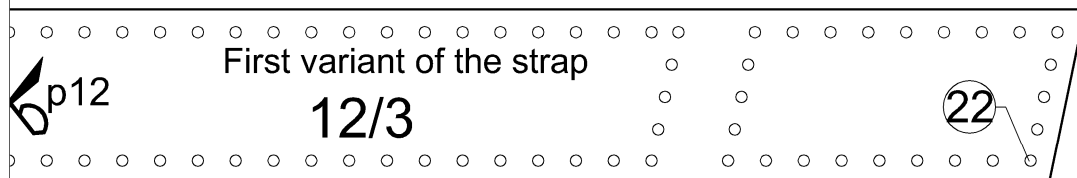
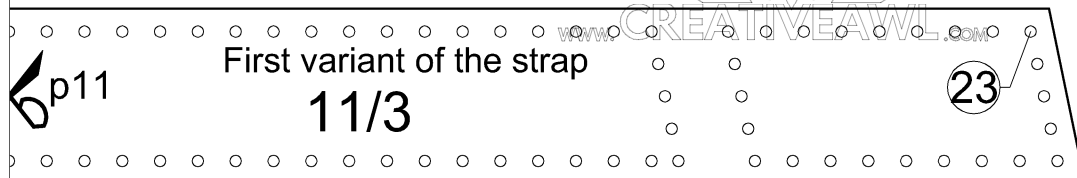
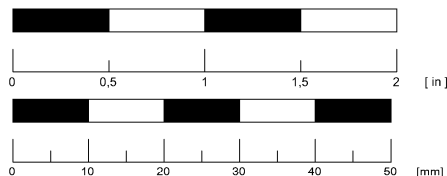
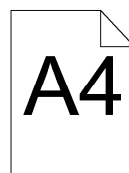
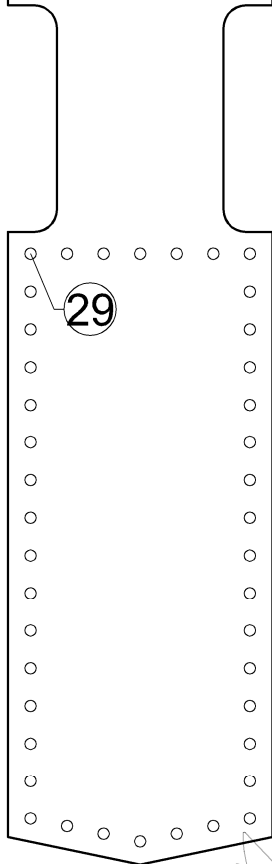
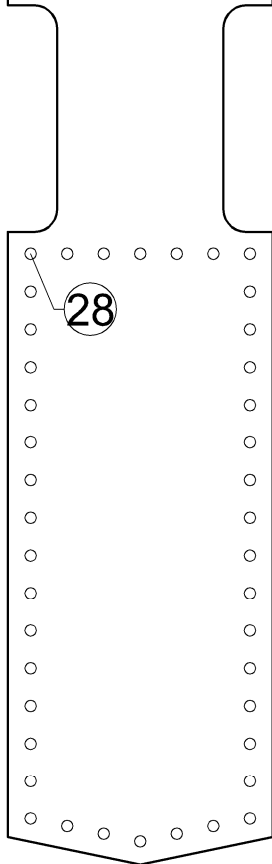
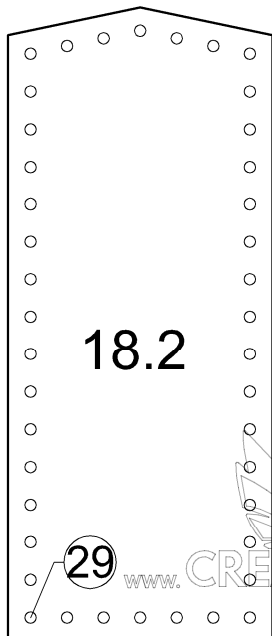
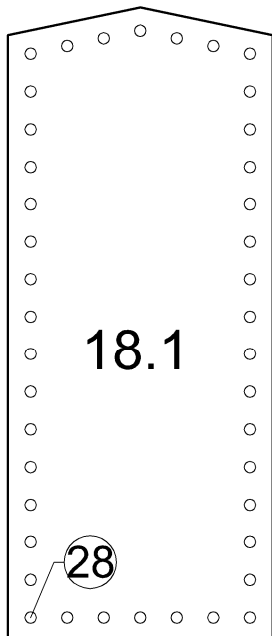

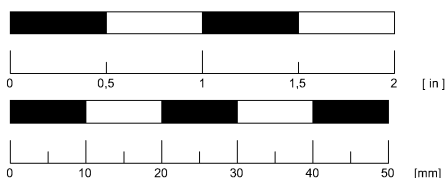
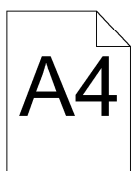
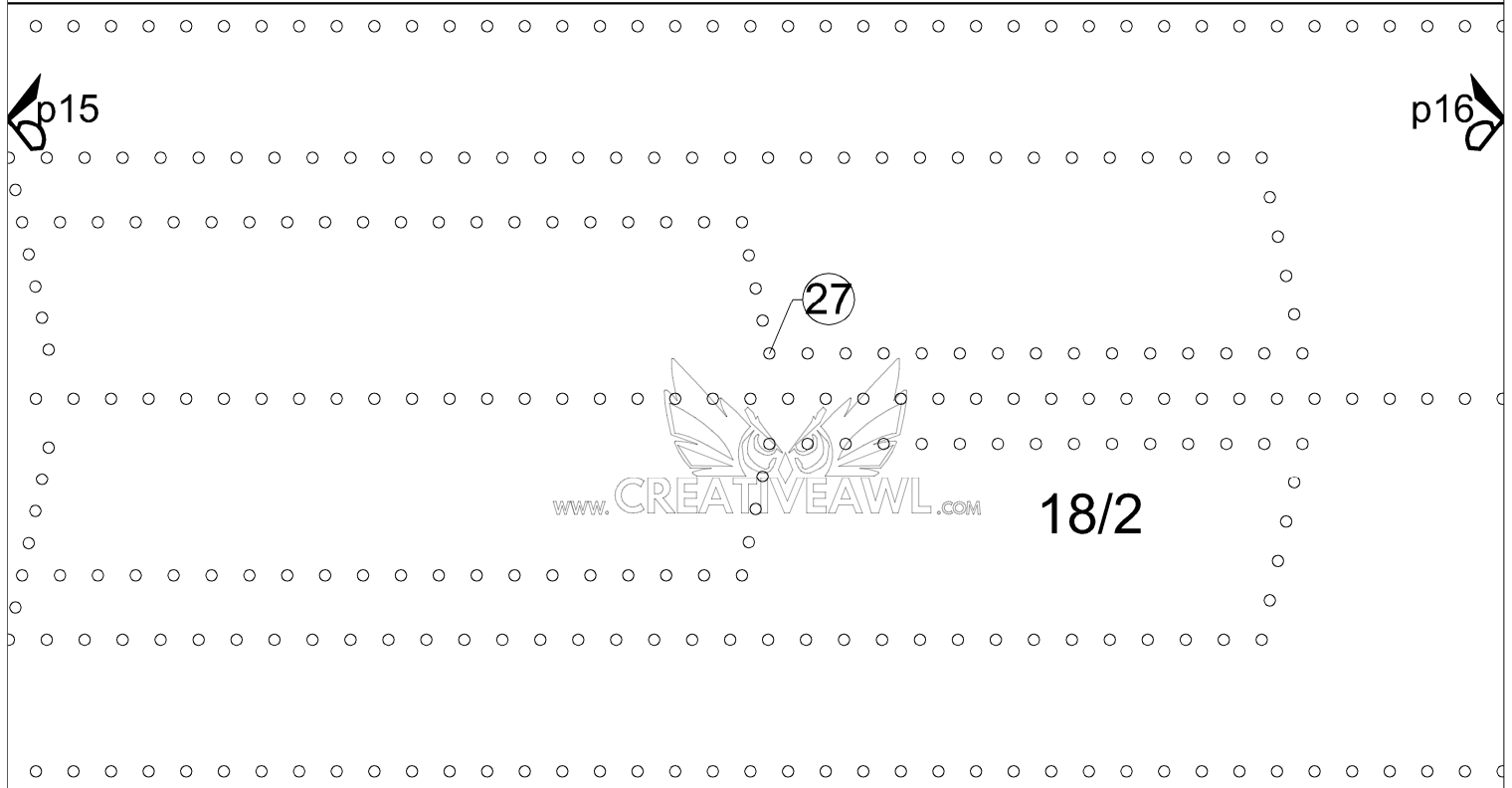
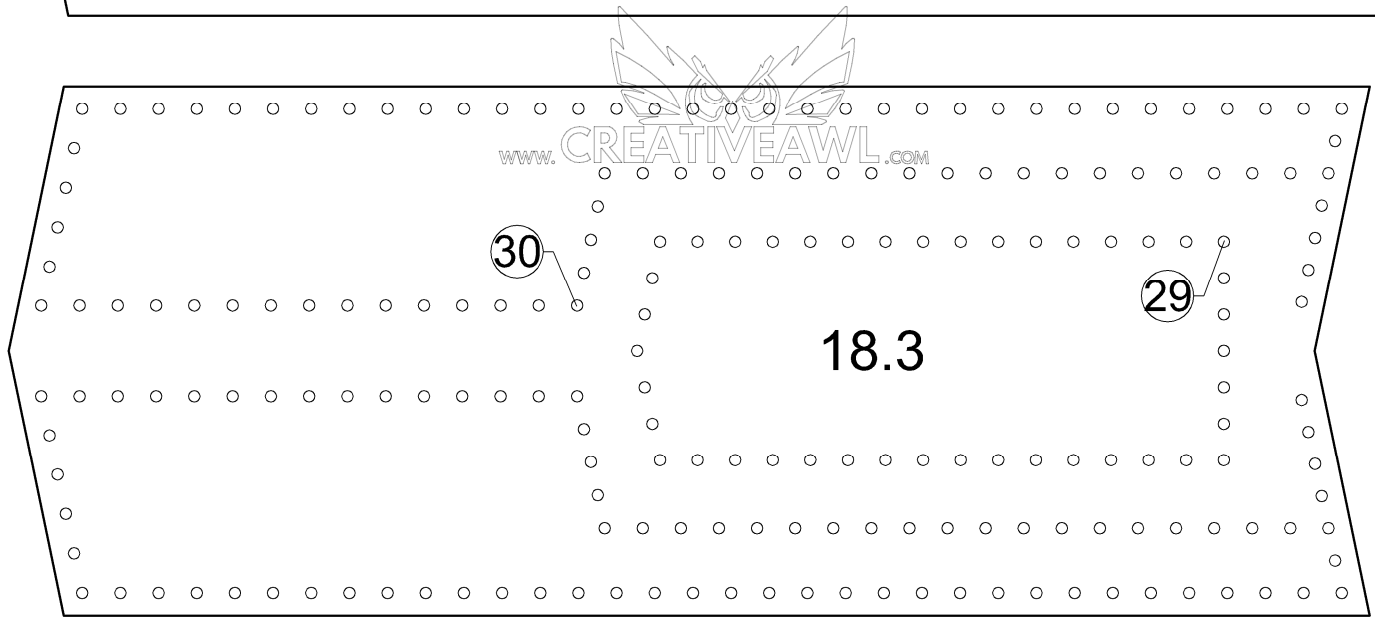
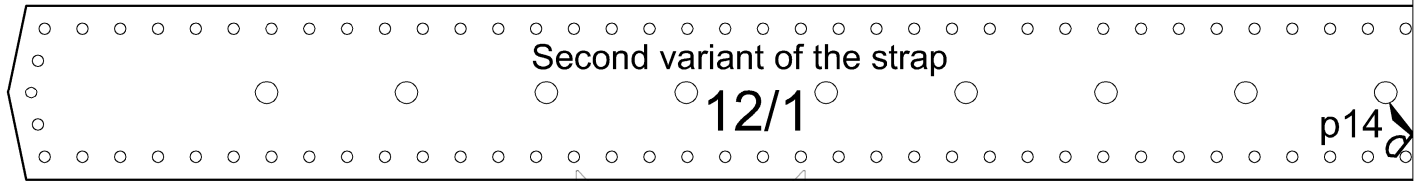
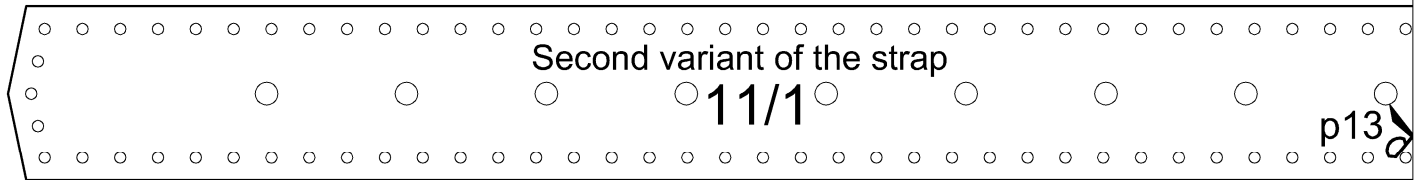



p13

Second variant of the strap

11/2

p20



p14

Second variant of the strap

12/2

p21



p16



p17





www.CREATIVEAWL.COM

31

18/3

p16



p17



www.CREATIVEAWL.COM

31

18/3



A4



0 0,5 1 1,5 2 [in]

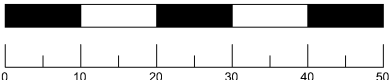

0 10 20 30 40 50 [mm]

Flap strips and
sides components 16

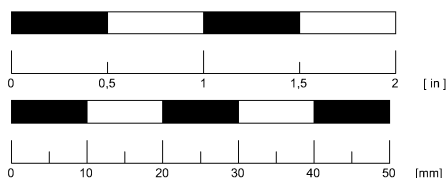
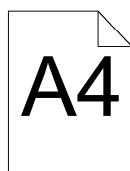
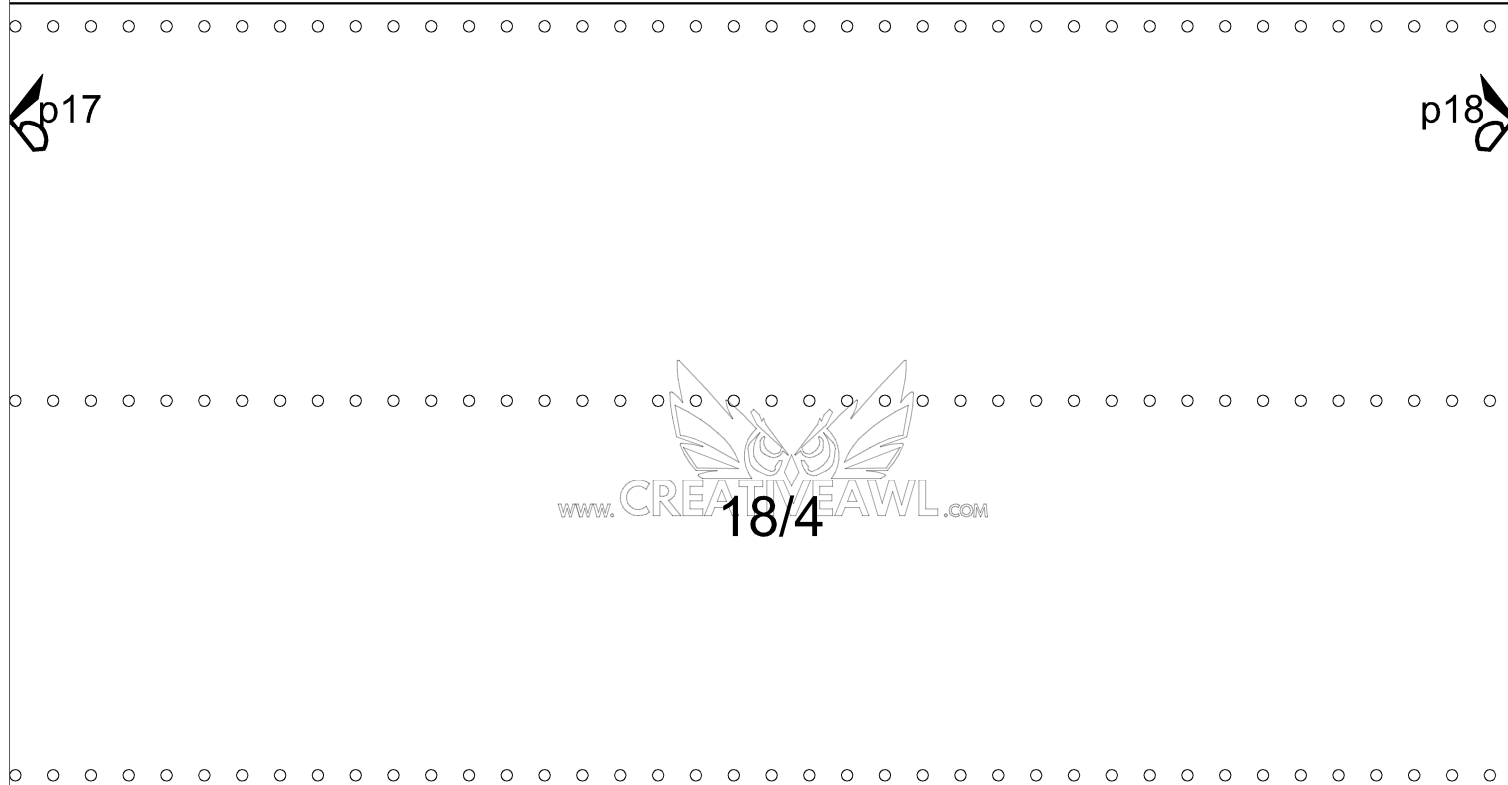
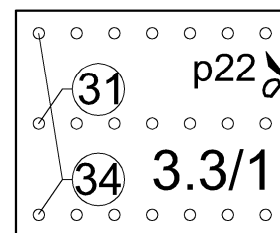
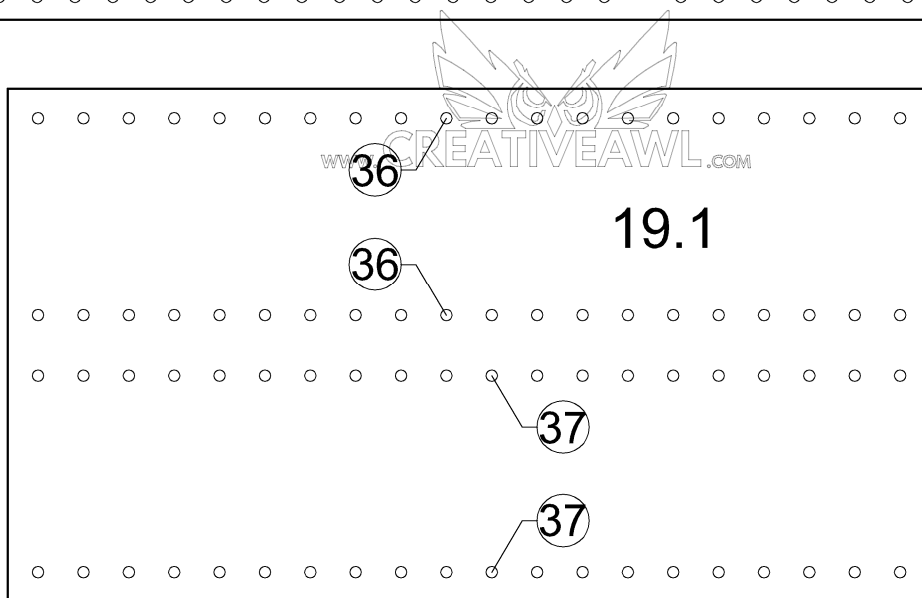
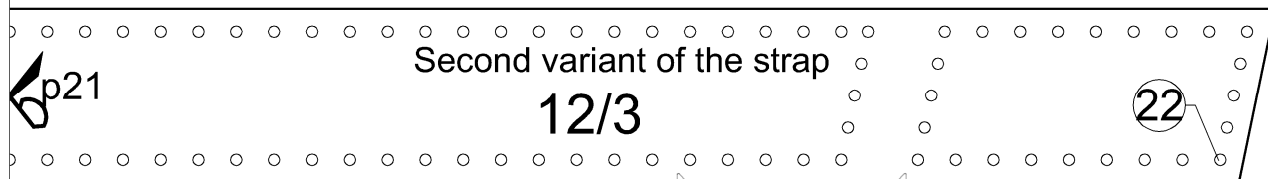
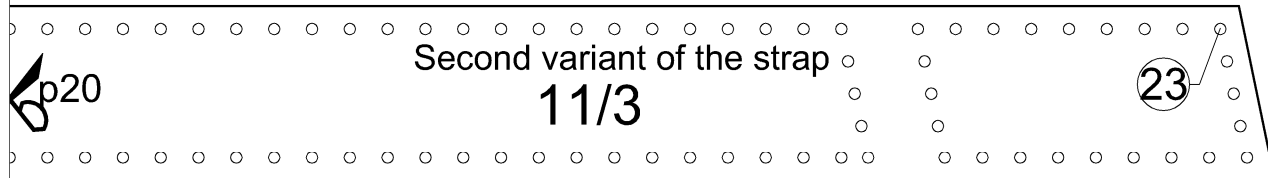

Flap strips, handle and
sides components 17

36

19.2/1

p26

26

3.1/1

p25 2

33

32

3.2/1

p24 

35

p22

p23

3.3/2

p18

p19

18/5

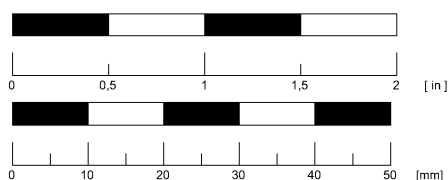
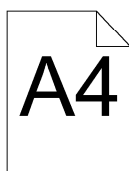

Handle and sides components

18

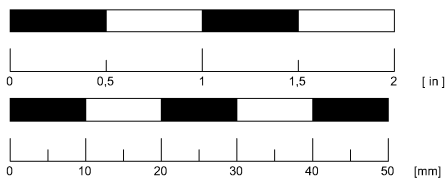
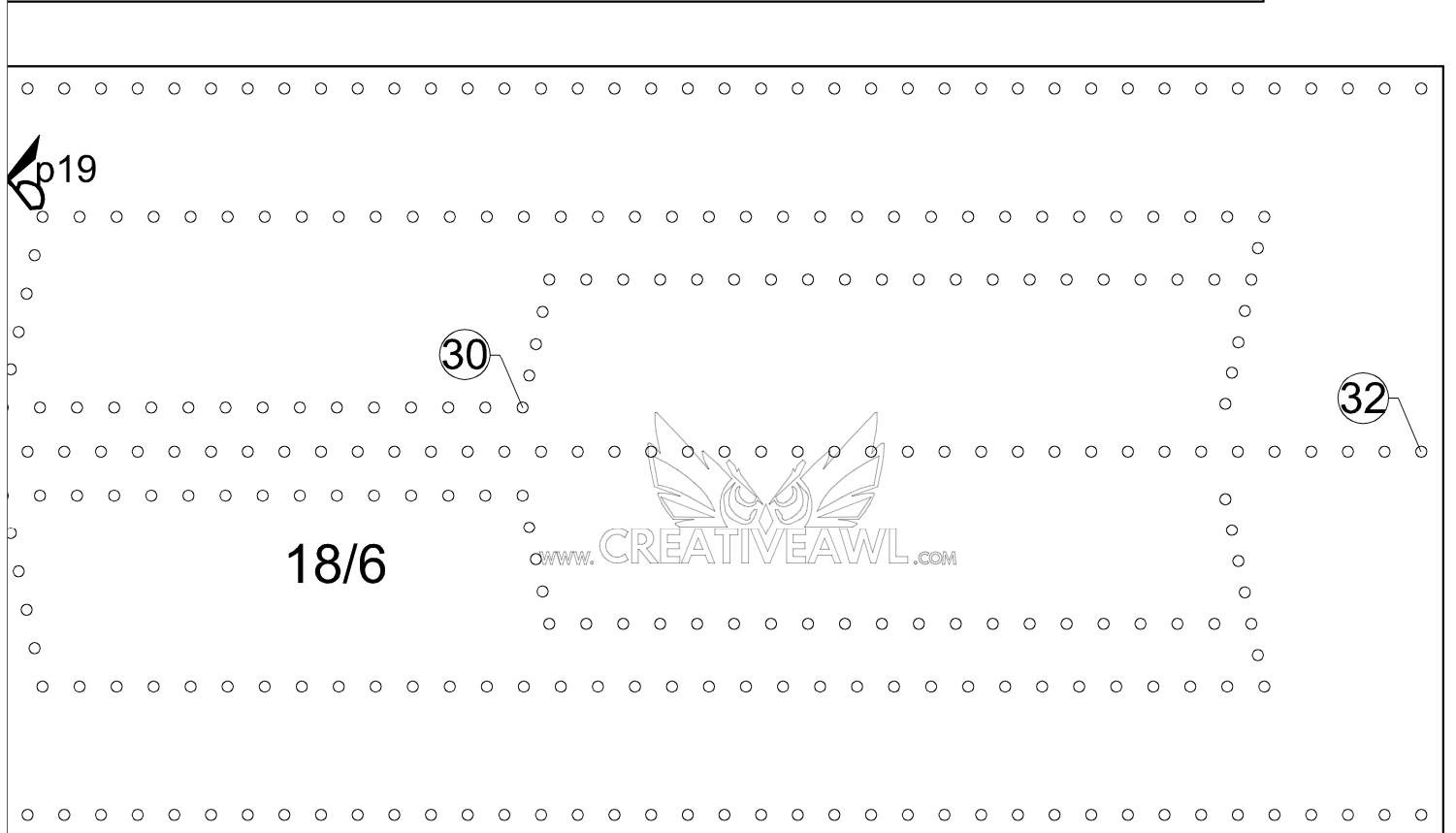
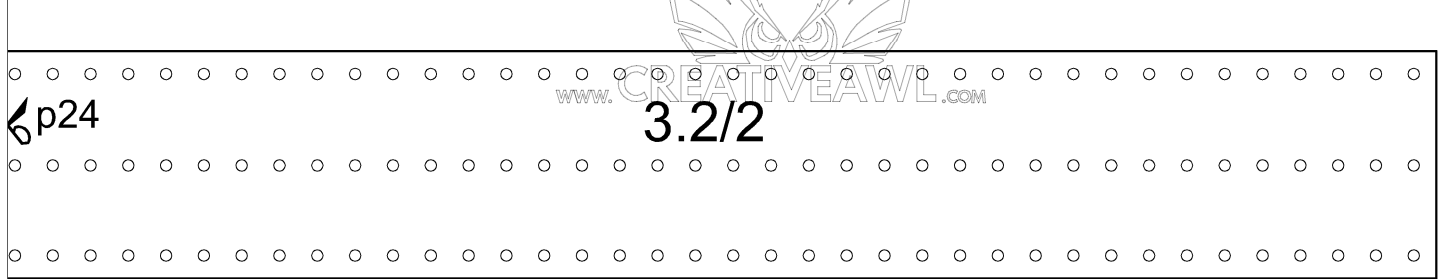
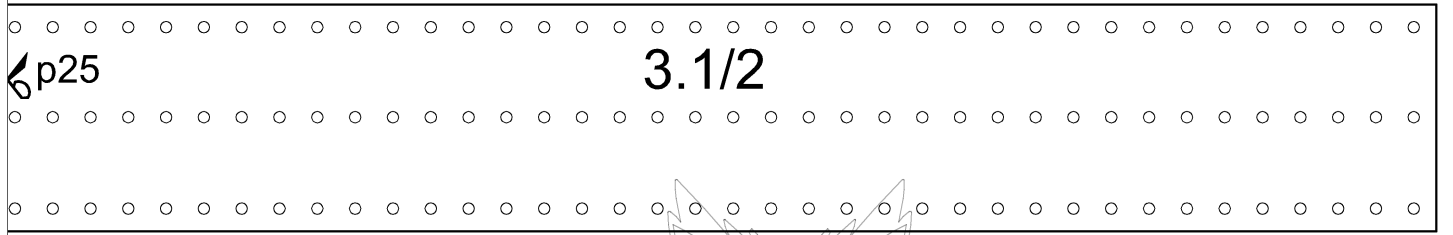
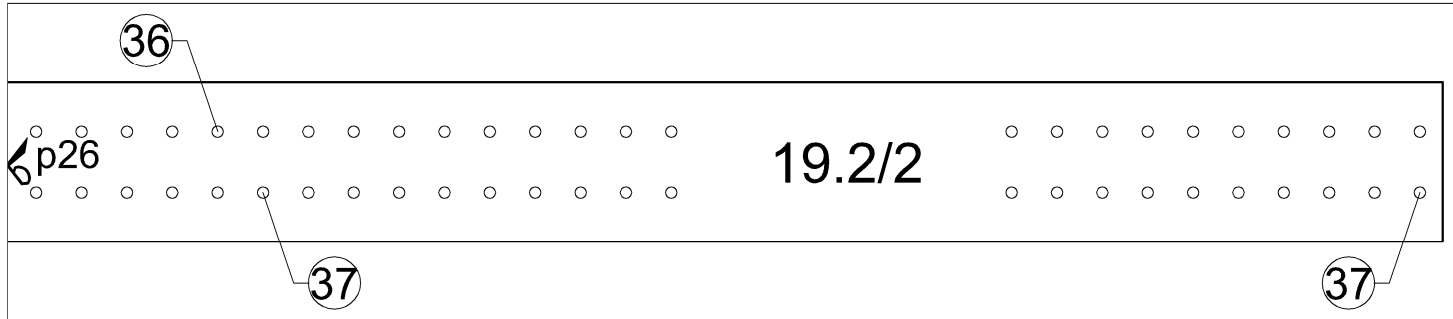

Handle and sides
components

Back bag

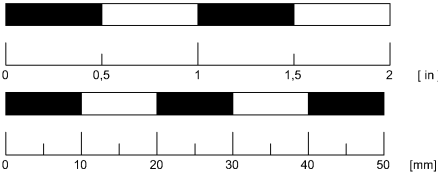

p27 

4/1



Back bag

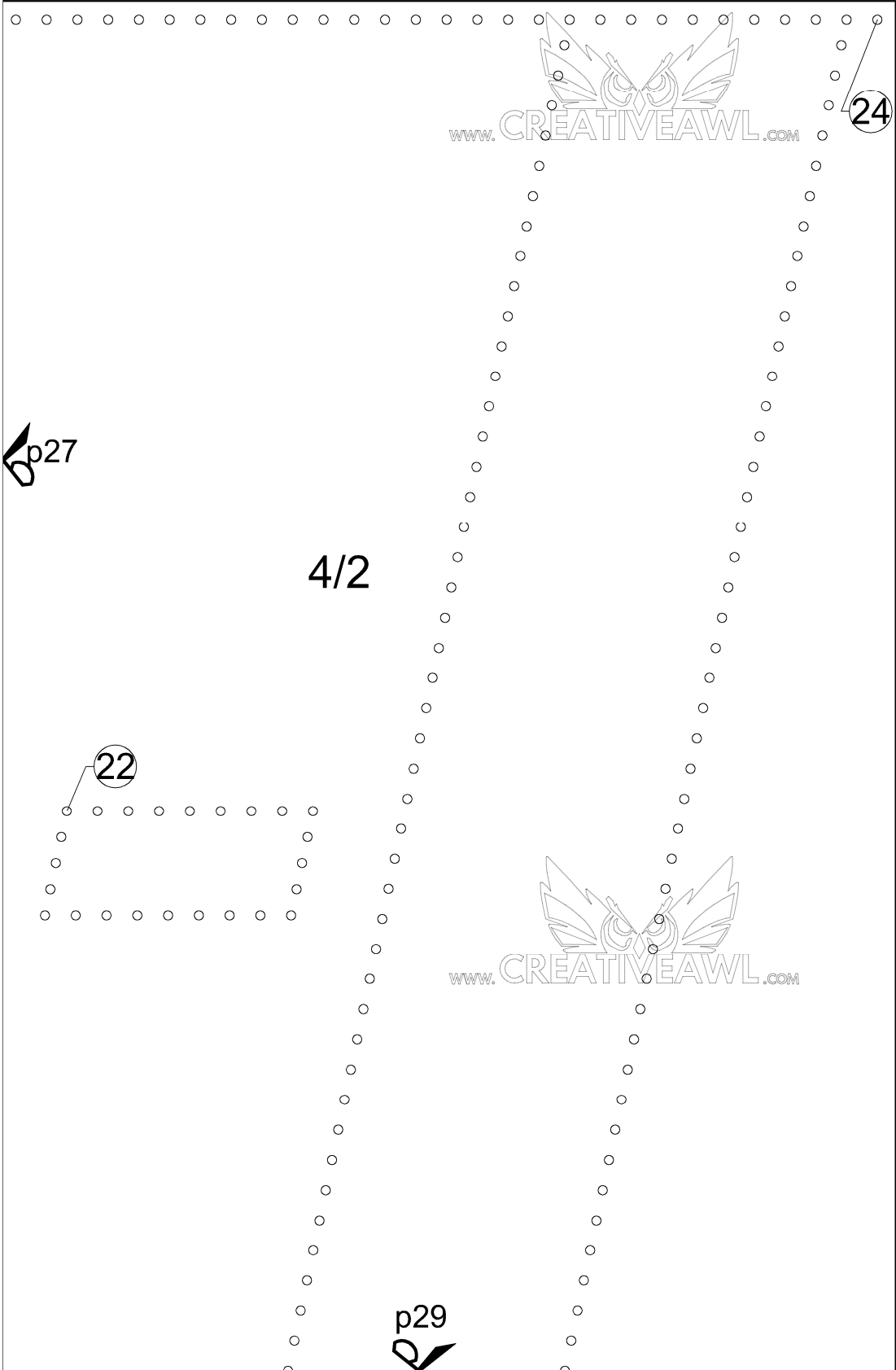
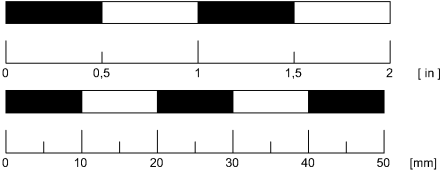



4/3

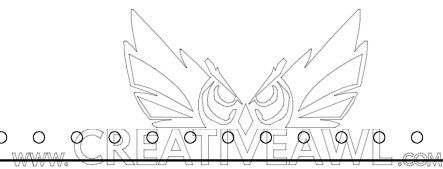

Back bag

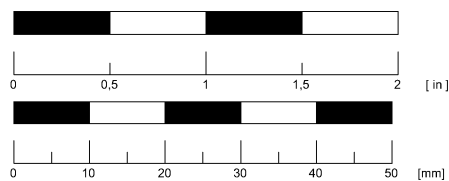
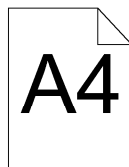

p29

9

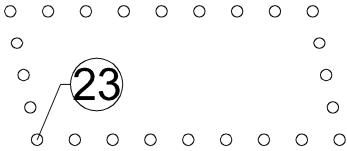

4/4

p30

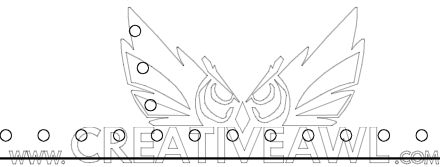
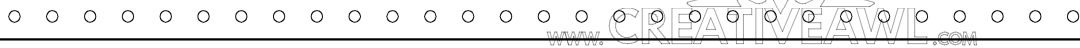

Back bag

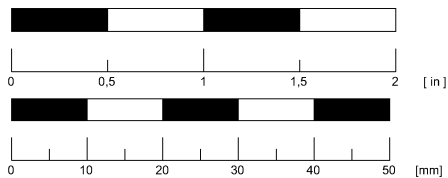
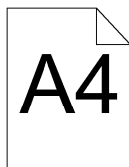

Back bag

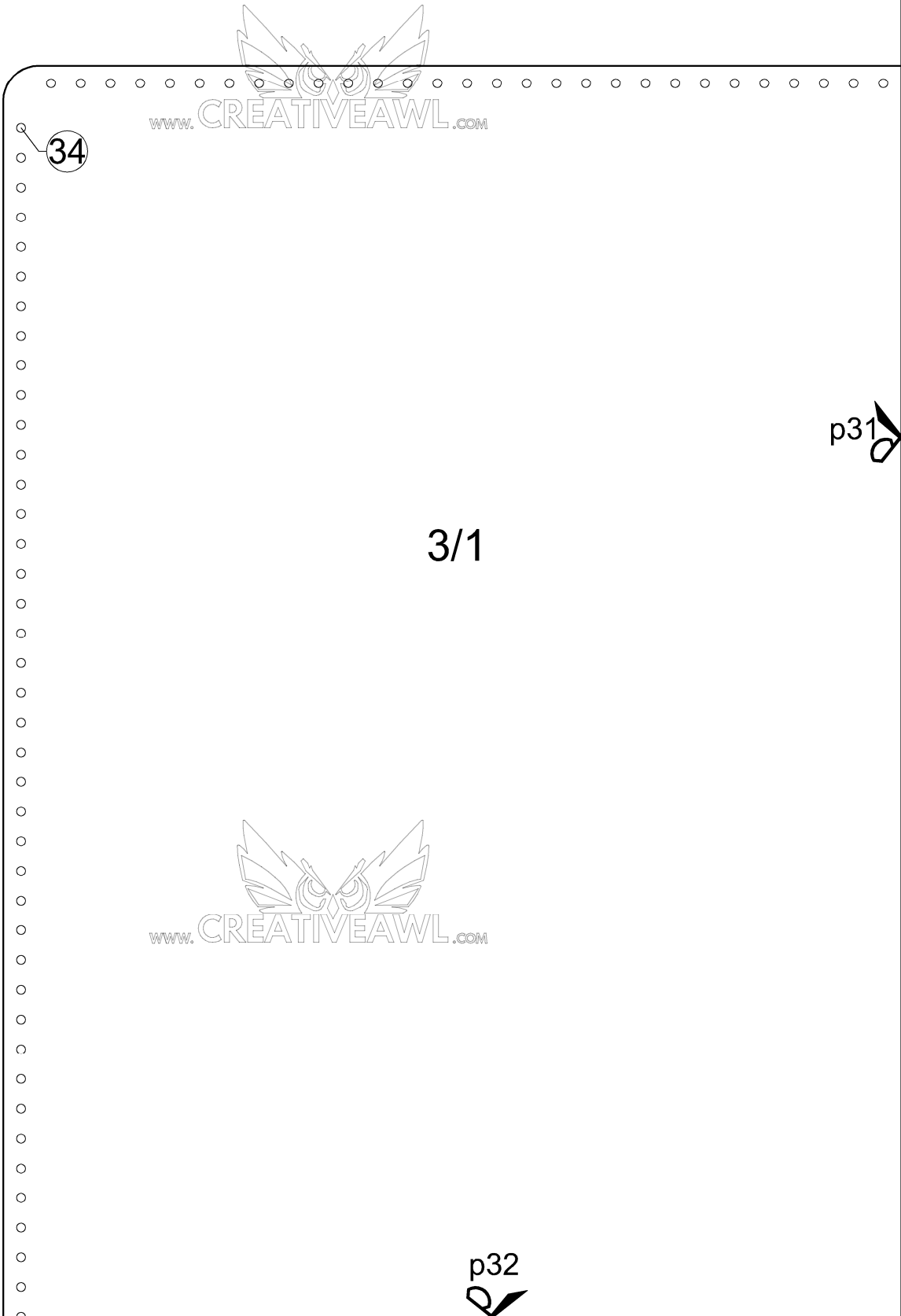
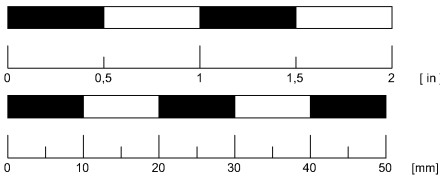

Back bag

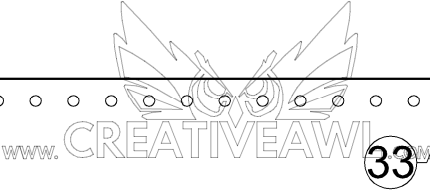
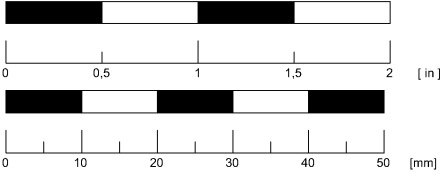

p31

3/2



p33



3/3

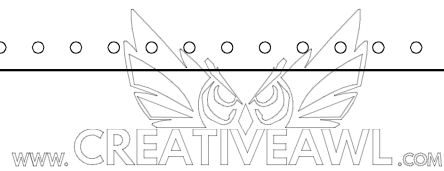

Back bag

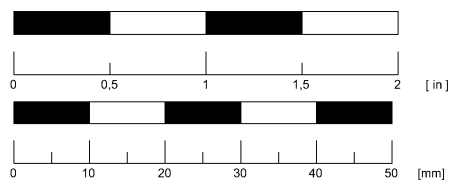
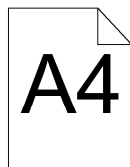



3/4

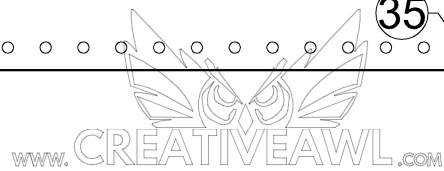
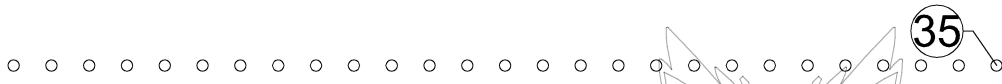

Back bag

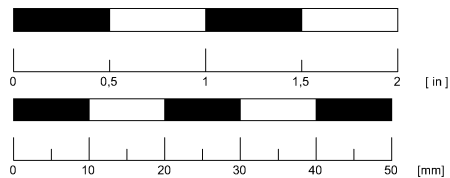
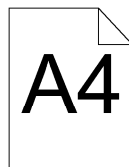

!!! Instead of a seam, you can put rivets
Legend:

✕ : rivet hole

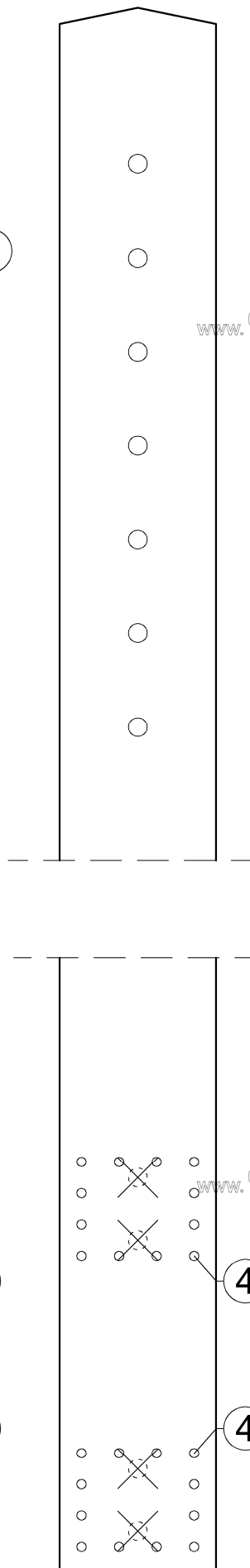
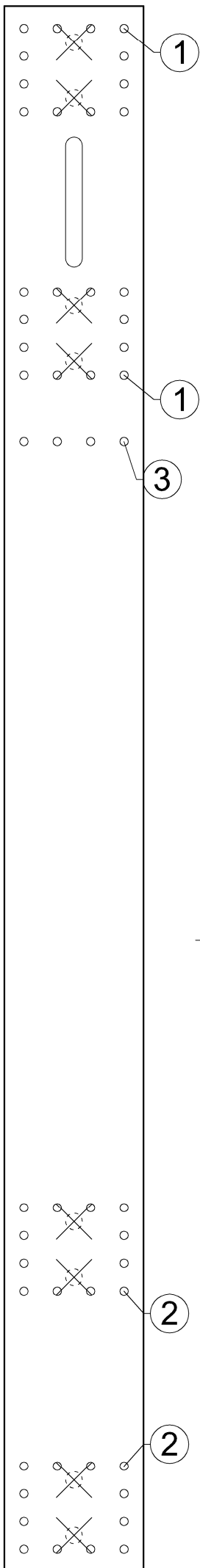

about 110 - 130 cm (44 - 52 in)

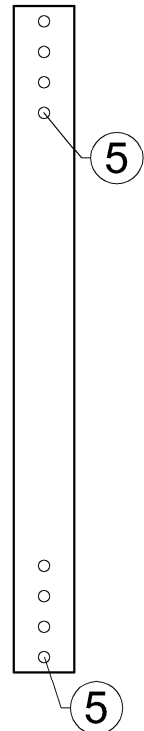
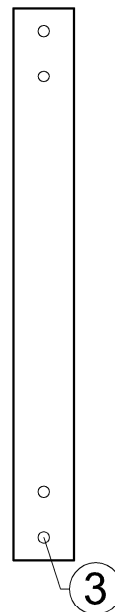

shoulder strap
"25 mm"

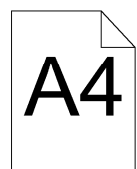
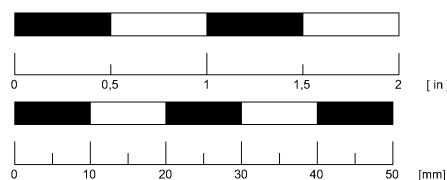

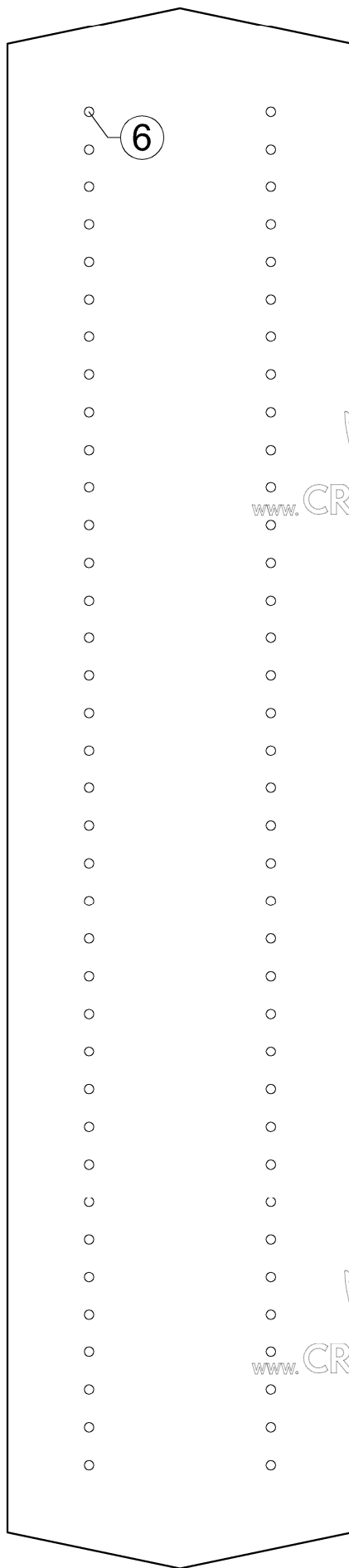

shoulder strap
"25 mm"

